

Safety and convenience

JOST

Innovative solutions for
demanding tasks

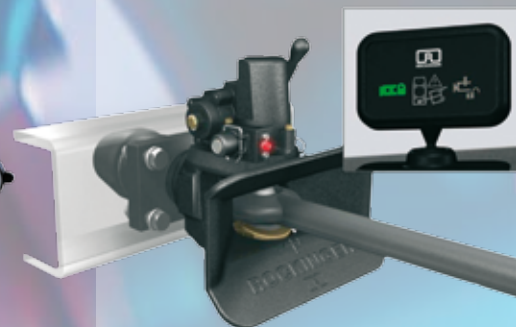

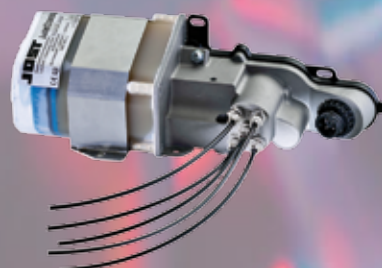

Innovations from JOST: Safety and convenience to suit any need

A modern vehicle fleet places complex demands on operators and drivers. It is thus essential to make it as safe as possible to operate the vehicle, to keep down the standing time and to avoid accidents. JOST has therefore developed various systems that build on each other like stepping blocks to automate or support manual procedures; they thereby not only increase safety, but also efficiency.



Flashtronic Simply safer

The design of today's commercial vehicles makes it harder to check fifth wheel couplings manually. Flashtronic uses a sensor to check the locking position. A blinking light diode indicates that the lock is closed and secured. This means that the locking position can be inspected quickly and reliably, even in conditions of poor visibility.

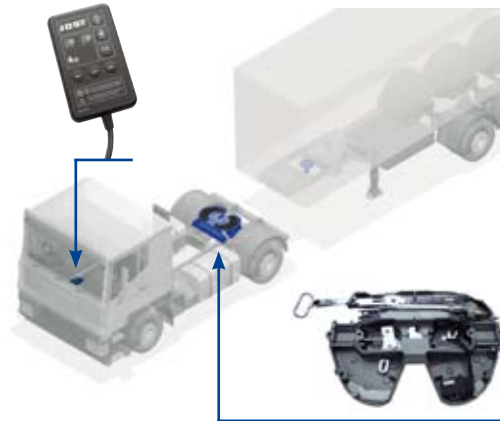

Sensor Coupling

The safe solution with remote display

- A sensor permanently monitors the locking status while another sensor controls the position of the king pin.
- The remote display in the driver's cab indicates the locking status both visually and with sound.
- A third sensor shows the correct coupling height in the cab.

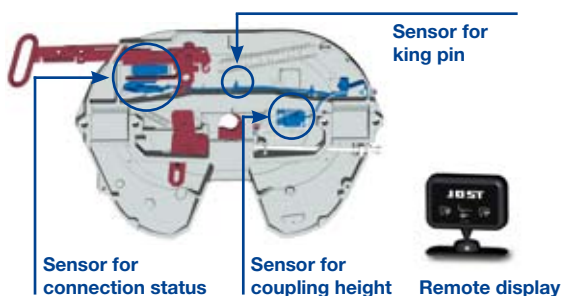

SKS

Sensor coupling system with remote control

In addition to monitoring, the SKS sensor coupling system offers the opportunity to remotely control the fifth wheel coupling. The fifth wheel coupling no longer has to be opened manually when uncoupling – this is done easily from inside the driver's cab via a pneumatic remote control.

- Opens at the press of a button, even with a twisted tractor unit or when there is little room to manoeuvre.
- Unnecessary shunting and fiddling become a thing of the past.



KKS

Completely Automated

The innovative KKS automates all manual coupling procedures.

- An automatic plug-in connection for pneumatic brakes and electric equipment on the trailer – no spiral cable needed.
- Fifth wheel coupling with remote control and remote display – prevents coupling errors
- Electrically-powered landing gear – no cranking.

Electronic control and monitoring increase safety and efficiency:

- The risk of an incorrect or careless coupling procedure is considerably reduced
- The risk of accidents for operators and third parties is reduced since the driver does not have to get in and out of the cab repeatedly and no longer has to do the coupling manually.
- All system components are monitored electronically
- All components can continue to be fully mechanically operated.





LubeTronic

Always well lubricated

Lubricating fifth wheel couplings is one of the necessary but not always the most popular jobs to be done in the vehicle fleet. It especially causes downtime and ties up personnel. With its LubeTronic product range, JOST offers a variety of lubrication solutions that help save time and money.

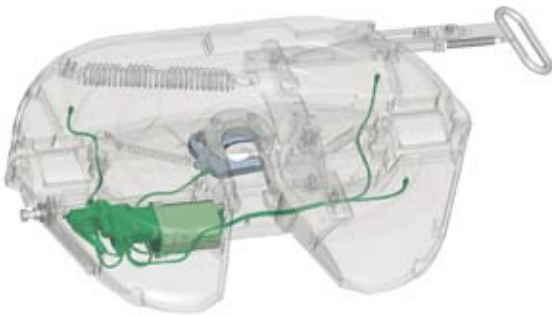

Thanks to the top-plate liners, low-maintenance fifth-wheel couplings (Series W) do not have to be lubricated on the coupling plate, but rather only on the lock-jaw. The use of LubeTronic combined with a specially-coated lock jaw also eliminates this procedure. The fifth-wheel coupling is supplied with a precisely-measured quantity of fat for up to three years.

The LubeTronic *5Point* was developed for fifth-wheel couplings without top plate liners. This is a lubrication system integrated into a fifth-wheel coupling. Because it is equipped with its own battery and drive system, it operates independently of the on-board electrical system and can be installed quickly and easily. The constant dosing of a carefully measured quantity of grease



reliably lubricates the top plate liner for about a year. Afterwards, the cartridge can be refilled.

Using the LubeTronic also makes things considerably easier for the dual-height fifth wheel system (JSK DH). Combined with the low-maintenance JSK 37 EW, LubeTronic automatically greases the lock of the fifth wheel coupling and the joints of the dual-height fifth wheel system. This greatly reduces the time and effort spent on maintenance, cutting maintenance costs by up to 50 %.



For ROCKINGER towing hitches too, LubeTronic can take over the time-consuming manual lubrication done during maintenance work. The cartridge, which is filled with special oil, is an ideal supplement to lubricating the coupling with grease. Thanks to its own battery, the LubeTronic requires no power supply from the vehicle, which also makes it ideally suited for retro-fitting. It has a useful life of up to 18 months and is available with one or two lubrication points.



Upgrade kits: safe and practical

Today's design of articulated trains can lead to towing hitches to be difficult or impossible to reach. Upgrade kits from ROCKINGER provide greater safety and convenience. The remote controls are especially used for tractors where, according to Directive EC/94/20, there is not enough room to open the towing hitch with the hand lever. Depending on the design, they need less effort and have ergonomic hand levers. Remote displays and remote controls help to securely check the locking position and, thanks to the display in the driver's cab, the driver can save himself additional ways.

1. Pneumatic remote controls

The pneumatic variant brings power and convenience of use to opening and closing the coupling.

2. Electro-pneumatic remote control (40, 50 mm)

This variant facilitates not only coupling and decoupling – it also spares the walk: operation takes place from inside the cabin.

3. Electric remote display (one Sensor)

The electronic remote display also provides additional safety by checking the locking position of the coupling and displaying it on the rear of the truck. It is not necessary to lay cable through the truck.

4. Electric remote display (one Sensor)

The electric remote display offers more convenient safety by checking the locking position of the coupling and displaying this in the cabin.

5. Electronic remote display (two Sensors)

The electronic remote display offers complete safety by inspecting the locking position of the coupling and the cable and sensor connections, and then showing them on a display in the cab.

6. Drawbar turn angle warning system (50 mm)

The drawbar turn angle warning system prevents avoidable damage to the vehicle or the coupling.

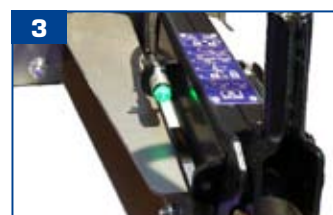

Products



1 Systems

Sensor-controlled systems monitor and automate manual processes, thus providing for more safety and efficiency in your fleet.



2 Fifth wheel couplings

We offer a wide selection of fifth wheel couplings, 2" and 3 1/2" in a wide variety of mounting heights, bearing types and models. The program is completed by mounting plates, sliders and dual height fifth wheel systems.



3 King pins

King pins are available in 2" and 3 1/2" for all systems in various models.



4 Modul landing gear

Any customer specs can be fulfilled thanks to the landing gear's modular construction with variable mounting and bolting heights, its differing crank and connection shaft lengths and its four different foot types. Furthermore, JOST offers a multitude of special landing gears for special applications.



5 Hubodometer

The range of products includes various hubodometers for calculating the distance driven, independent of the vehicle, for all types of wheeled vehicles.



6 TRIDEC

TRIDEC develops and produces independently manufactured mechanically and electronically controlled steering systems for trailers and wheel suspension systems.



7 Container equipment

Parts for alternating systems, supports, locks and bolsters, swap body lifting devices, guide rollers and bearings – all components required in a flexible fleet.



8 Ball bearing turntables

The ball bearing turn tables and slewing rings were the first products that JOST produced. The wide range of top-quality ball bearing turntables is based on this experience.



9 Drawbars and drawbar eyes

Drawbars and towing eyes are available in various models and can be designed to suit the customer's specific needs.



10 Towing hitches

There is a multi-faceted range of products for road traffic available – towing hitches, hook trailer hitches, towing eyes, accessories and special models.



11 VARIOBLOC

VARIOBLOC is a multi-functional alternating system for transporters, cross-country vehicles and busses. Courtesy of a quick-change plate, it enables towing hitches, hitch balls or hook trailer hitches to be changed rapidly.



12 Agricultural hitches

An extraordinarily extensive range of products for agriculture and forestry: Towing hitches, trailer hitches, clutch carriers, towing eyes, drawbars and accessories.

JOST



REGENSBURGER
ZUGGABEL

